





ASLAAN®



Arugalai Series

Aslaan WiFi Remote
Installation Guide



Doesn't need Internet 
 Mobile WiFi Required



Arugalai is a Wi Fi based Smart Controller Device. It is a Make in India product. Aslaan manufactured and designed the entire product in Tamilnadu. Arugalai works in 2 modes.

Auto Smart : It executes On & Off function as per the routines. It does not require mobile or internet to perform. Mobile Wi Fi is required during editing (add, modify or delete) routines. Absolutely no need of internet for its entire operation.

Remote : Random On & Off function by mobile is possible, apart from routines. Mobile acts as a remote. No need of IR remote.



Arugalai

Google Play

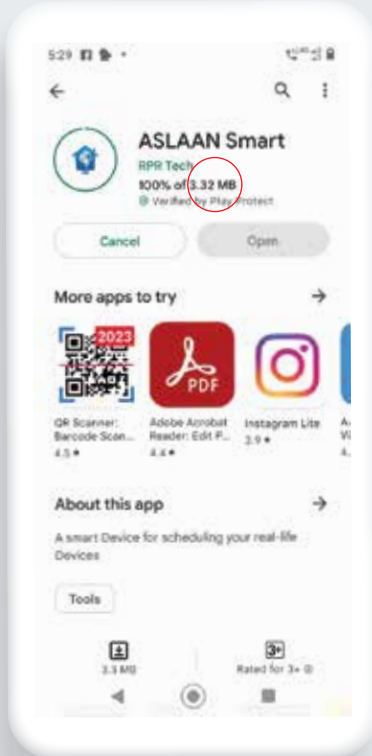
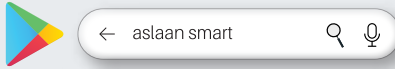

Install Aslaan Smart App from Play store. The App is small in size – 3.22 MB. It occupies small space of your phone memory. No need of submitting your personal data like e-mail id, location or phone number during installation.



Switch off mobile data and switch on mobile Wi-Fi.



Arugalai



Open Aslaan App.



Arugalai

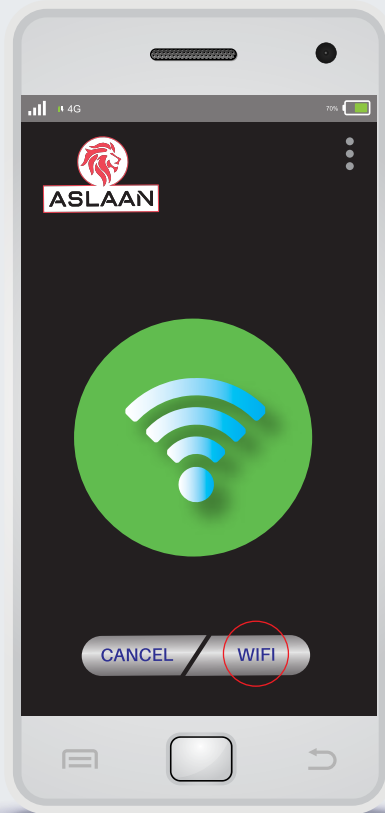

Touch Wi-Fi in the App to establish connection between your mobile and Arugalai product.

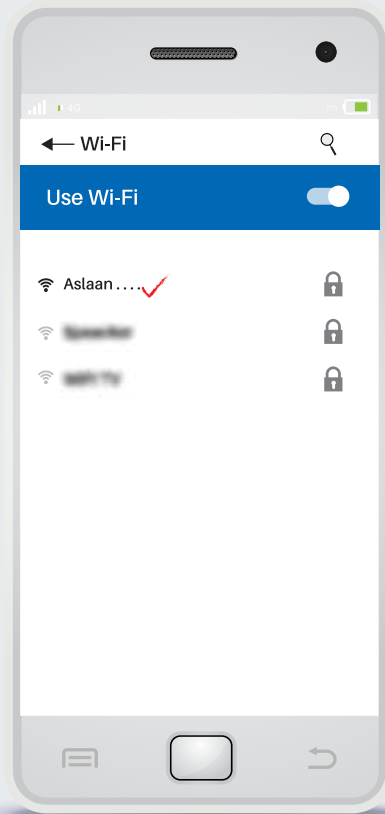

Choose `Aslaan.....' from the available Wi-Fi networks listed.

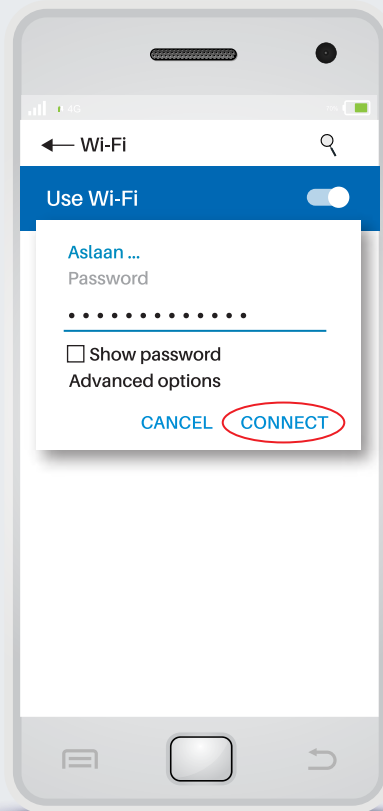

It demands a Password. Enter the password mentioned on the backside of the Arugalai product and press 'CONNECT'

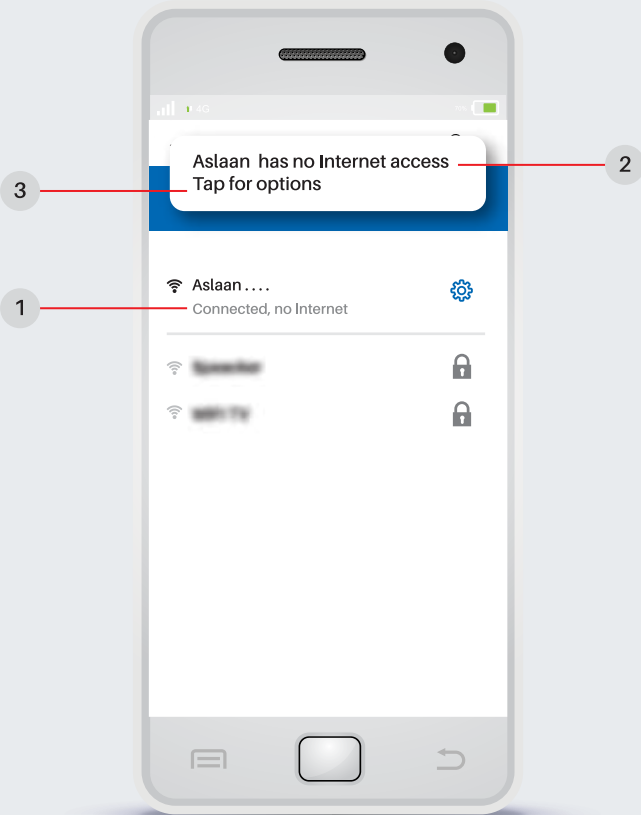

A response 'Connected, no internet' - ① will come. After a few seconds, you will see a message 'Aslaan has no internet access' - ② 'Tap for options' - ③

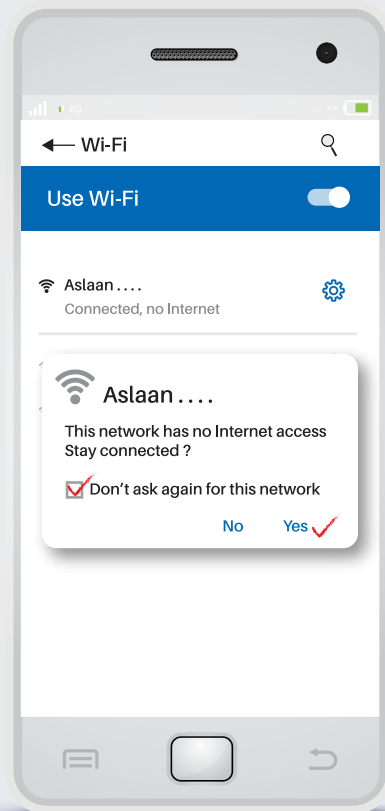

Choose 'Yes' in order to keep your mobile to be in the 'Aslaan.....' Wi-Fi connection, by tapping 'Tap for options'.



Arugalai

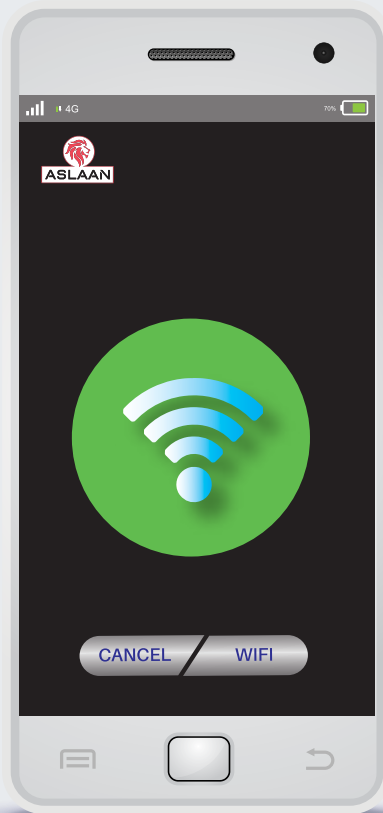

Initial screen flashed

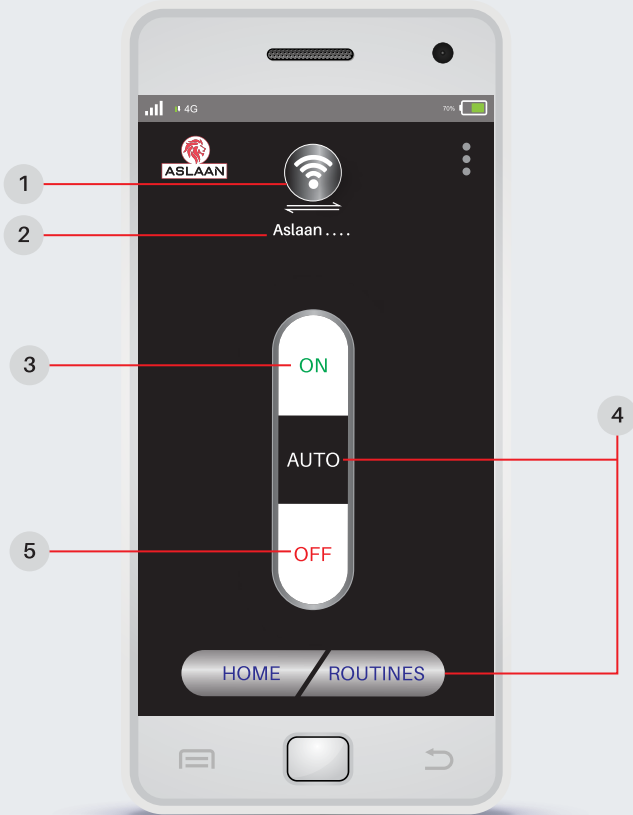

This screen indicates that, Mobile and Arugalai Products are connected. Now you can start controlling the product through mobile

- 1 This key enables you to switch between one another, while, more than one number of Arugalai products installed at a place.

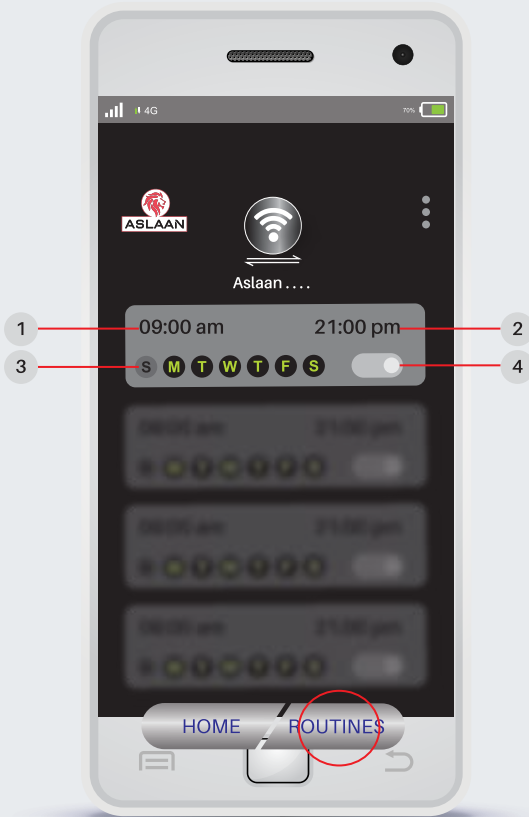

Routines : You can set **4 routines**.

- 1 ON - Time
- 2 OFF - Time
- 3 Days to execute the above said routines
- 4 ENABLE / DISABLE of that particular Routine

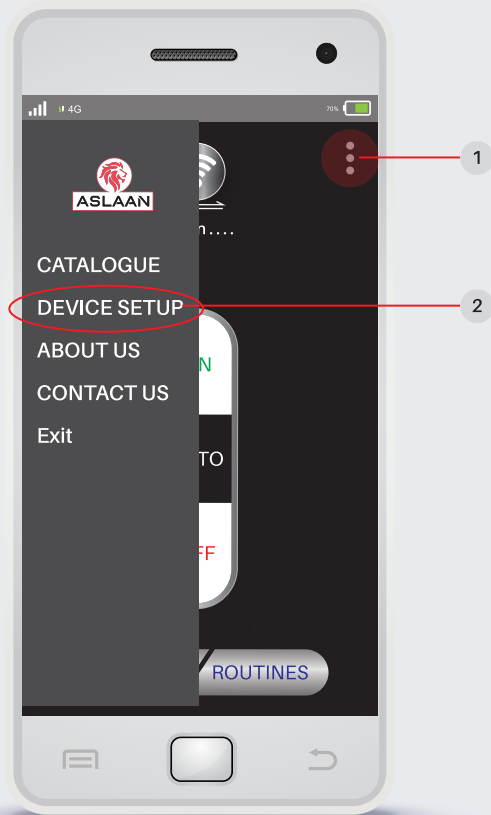

Other functions by selecting 3 DOTS 1

Device set up 2 You can change the Wi-Fi name for your convenience (refer page number 14)

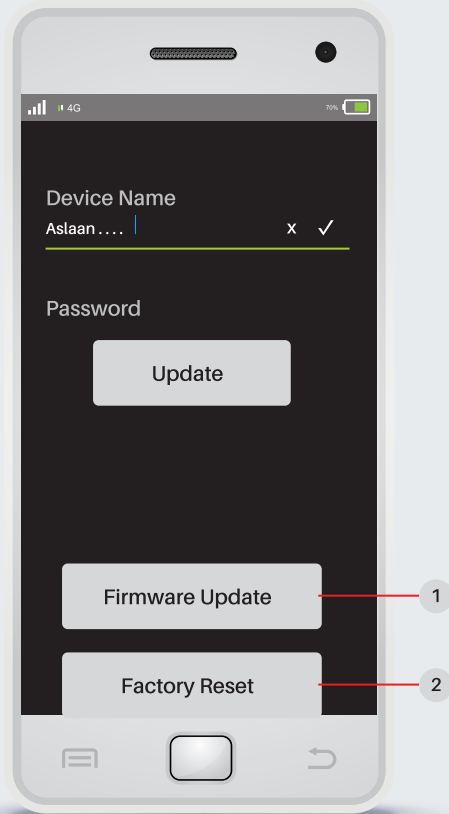

Change both `Device name` & `Password` simultaneously. Password should have minimum 8 characters. Not permissible character is `?`

Press `Factory Reset` - 2 while you are confused about device name or password you typed. It will go back to the starting device name `Aslaan.....` and Password of that time.

While you receive any notification about Software Update use this `FIRMWARE UPDATE` key to update. Usually, it will be carried out automatically.

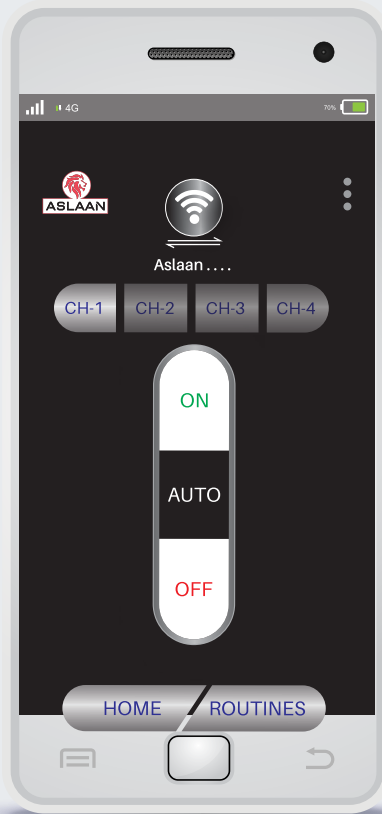

This is 4 Channel App screen. Controlling 4 electrical products through single Arugalai Wi-Fi is possible. 4 individual routines available for each channel. It is available as Concealed switch box and extension box. (refer page number 5).



Power on the Arugalai product.



Arugalai

2 The name of the Arugalai Wi-Fi, which you are using at present. You can rename it, for your convenience. Example : You buy a Arugalai Gate Light. So, change this Wi-Fi name as `Gate Light` instead of `Aslaan.....` Refer Page number 18 for more info.

3 ON switch

4 AUTO / ROUTINES - These two jointly enable to set and execute working times.

5 OFF switch

Try `ON` & `OFF` switches.

The example picture says :

Switch ON by - 9.00 AM

Switch OFF by - 9.00 PM

On all days except SUNDAY

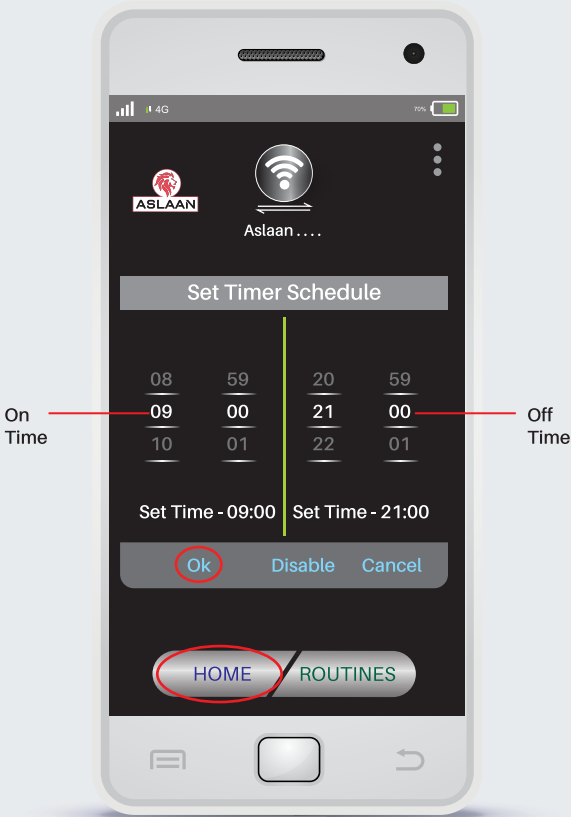

To execute this Routine Touch **Home** button

Put the Arugalai product in `AUTO` mode.

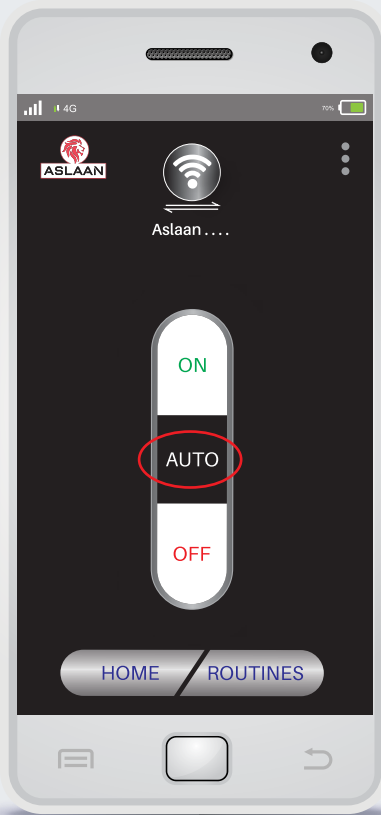

Arugalai product functions according to this routine automatically. There is no need of any type of external connectivity like your Mobile Wi-Fi or Internet.